

CONSULTANTS

Willis Hazell  
ENGINEERS

FRONT FIVE  
2011-2015

PROFESSIONAL SEAL:

REVISIONS				
Rev	Date	By	Description	
P07	18.08.25	RR	T16 Tree Added	
P08	26.08.25	RR	Boiler House Relocated	
P09	26.08.25	RR	South Foundation Line Ammended	
P10	01.10.25	RR	Boiler House Updated	
P11	16.12.25	FN	Updated to comments received	

- Site Boundary Line
- Proposed Fence Line
- New Turnstile
- Proposed Emergency Vehicle/Ob Compound Access Route
- Proposed Shared Footway / Cycleway
- Proposed Beryl Bike Space
- BNG & Landscaping
- Standard Car Park Space
- Disabled Car Park Space
- Electric Vehicle Space
- Proposed Cycle Parking
- Antiterrorism planters and bollards

**West Car Park**

34 No. Disabled Spaces  
4 No. EV Parking Spaces  
144 No. Car Spaces

**South Car Park**

347 No. Car Park Spaces  
40 No. Disabled Spaces



PROJECT: AFC Bournemouth

DRAWING TITLE: Site Plan

CLIENT: AFC Bournemouth

DRAWN: RR	DRAWING STATUS: PLANNING
APPROVED: DL	DATE DRAWN: 12/08/25
SCALE: NTS @A3	JOB NO: 25017.5
SUITABILITY: A1	REVISION: P11

DOCUMENT ID: 250175- STA - XX - XX - DR - A - 3001

The copyright of this design drawing belongs to Stadium Structures LTD. without authorization it is allowed to be used in specific projects, otherwise, the company reserves the right to pursue legal responsibility. COPYRIGHT © 2025

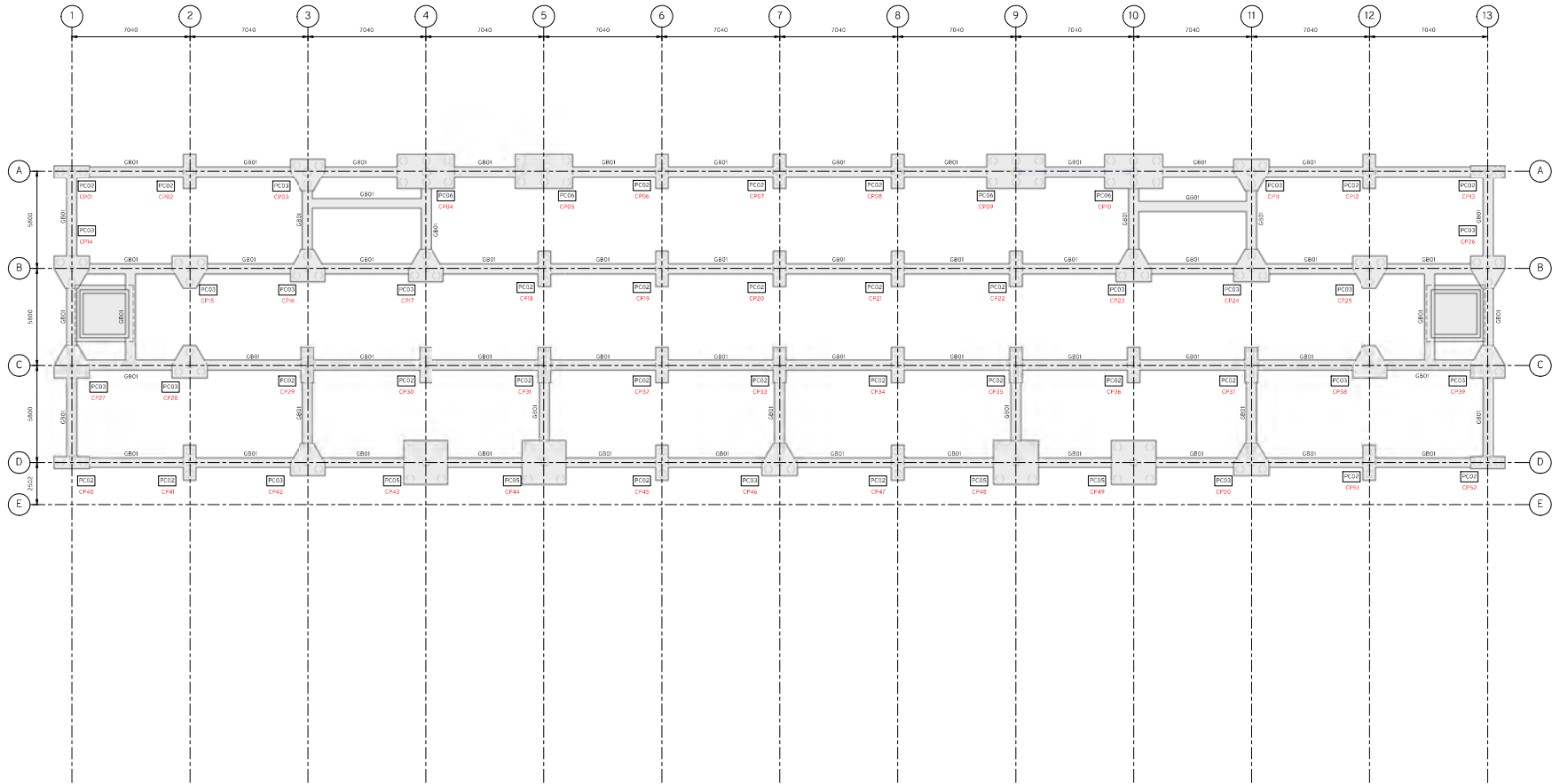

Pile Cap Schedule					
Type Mark	Pile Cap Dimension			Pile Information	
	Length (mm)	Width (mm)	Depth (mm)	Number	Embedment (mm)
PC02	2600	750	1010	2	450
PC03	1950	2100	1010	3	450
PC05	3650	3650	1010	6	450
PC06	3450	2100	1350	6	450

Ground Beam Schedule		
Type Mark	Width (mm)	Depth (mm)
GB01	800	800

Notes

- All dimensions are in millimetres and levels in metres unless noted otherwise.
- The drawing is to be used in conjunction with all relevant Architects and Engineers drawings, specifications and general notes.
- This drawing has been produced electronically and may have been photo reduced or enlarged when copied. Do not rely on any scales quoted. Work only to figured dimensions (do not scale). All dimensions to be checked on site. Any errors or omissions to be reported to the Engineer immediately.

Site Plan

Legend

PC001 Pile Cap Type (Refer to pile cap schedule for size)

PC02 Pile Cap Mark (Individual reference)



Reference

Document Title	Document Status
AFCB-WHE-SS-FN-DR-S-21001	Piling Schedule
AFCB-WHE-SS-FN-DR-S-21002	Piling Layout
AFCB-WHE-SS-FN-DR-S-21003	Pile Cap Details

Rev	23/08/23	Mr	Issued For Information	JB	Rev
Rev	01	Drawn	Description	CHKS	App'd

Status

PRELIMINARY

Client	Contractor
	

Civil & Structural Engineer



Project Title

AFC Bournemouth Stadium Development

Drawing Title

South Stand Foundation Layout

Suitability Status

S2 - Information

WHE Project Number	Scale @ A0	Rev
1070	1:100	P01

Drawing Number

AFCB-WHE-SS-FN-DR-S-21111



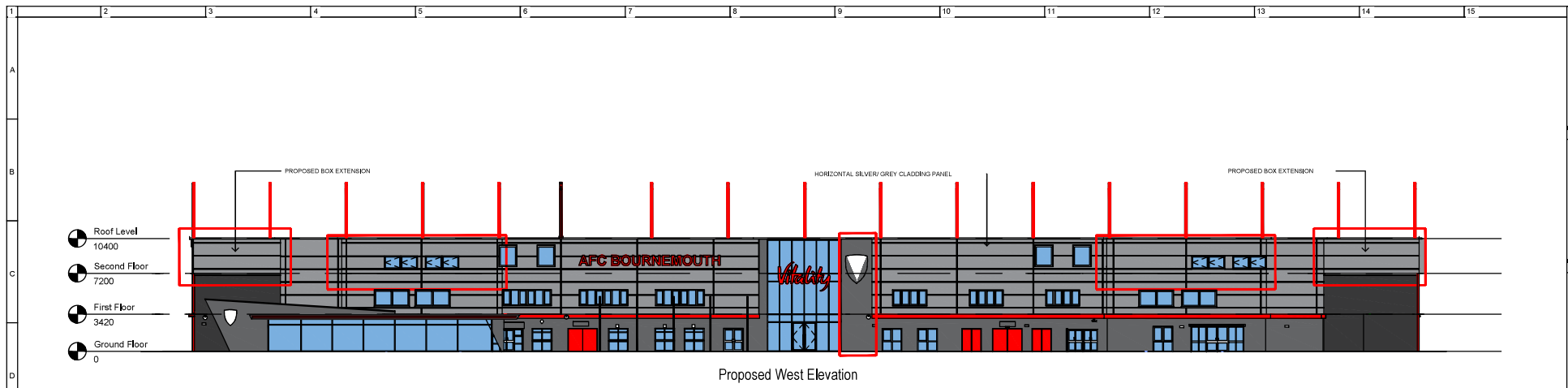

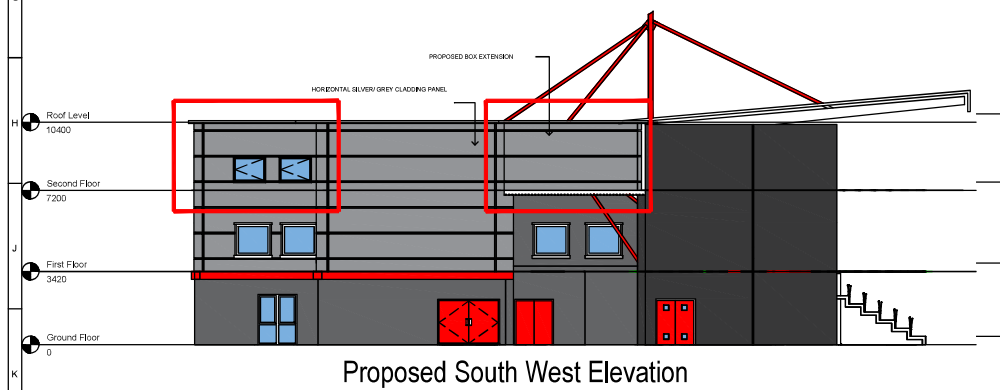

Scale: 1:400

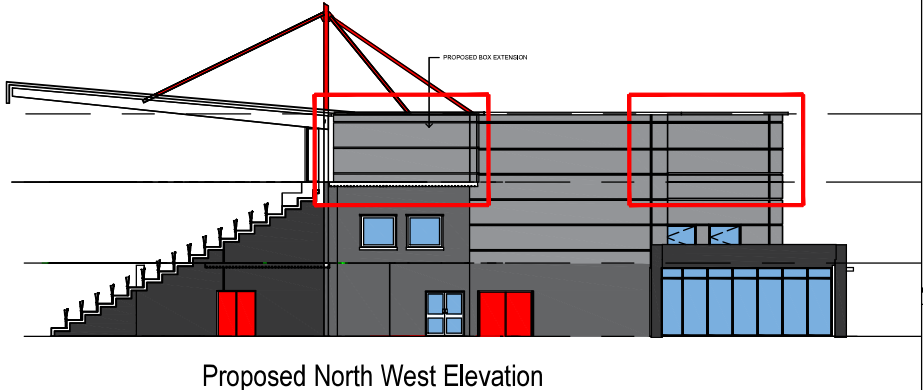

Scale: 1:250



Scale: 1:250



STADIUM  
STRUCTURES



Willis Hazell  
ENGINEERS



FRONT FIVE

PROFESSIONAL SEAL

Rev	Date	By	Description
PD1	06.08.25	RR	Updated to comments received
PD2	29.08.25	RR	Updated to comments received
PD3	26.09.25	RR	Scale Adjusted



**AFC Bournemouth**  
Vitality Stadium  
Dean Court  
Kings Park  
BH7 7AF

PROJECT  
AFC Bournemouth

DRAWING TITLE  
West Grandstand Elevations

CLIENT  
AFC Bournemouth

Drawn	Checked	Status
RR		PLANNING

APPROVED	DATE DRAWN
DL	07/08/25

SCALE	COORDINATE	REVISION	REVISION
Refer to drawing @A3	25017,5	A1	PD3

250175 - STA - W - XX - DR - A - 1000

The copyright in this design shall remain with the Stadium Structures Ltd. All rights reserved. No part of this design may be reproduced without the prior written permission of Stadium Structures Ltd.



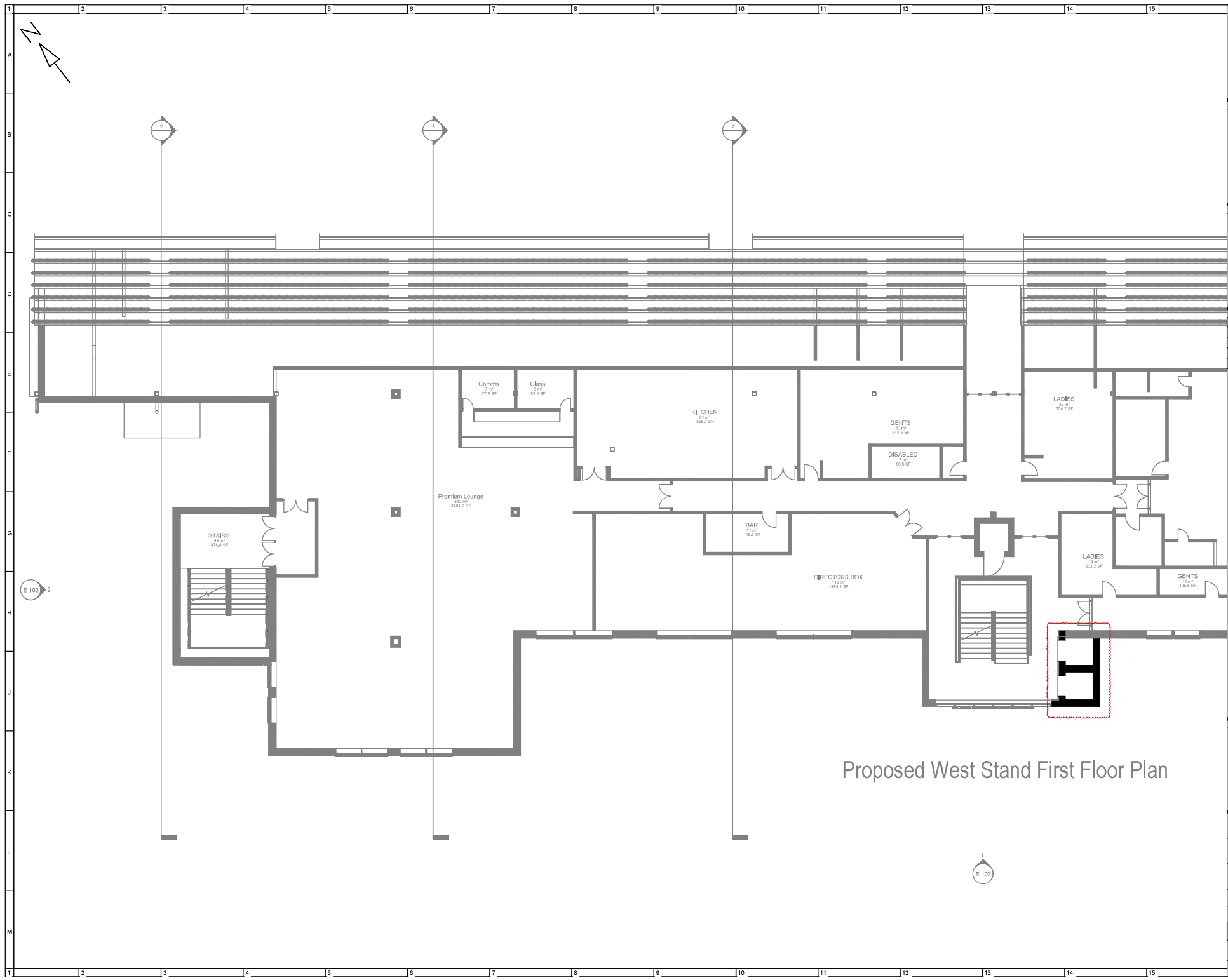

PROFESSIONAL SEAL

Rev	Date	By	Description
PD1	06.08.25	RR	Updated to comments received
PD2	29.08.25	RR	Updated to comments received

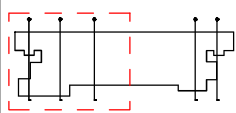

Proposed West Stand First Floor Plan



PROJECT			
AFC Bournemouth			
DRAWING TITLE			
Proposed West Stand First Floor 1/2			
CLIENT			
AFC Bournemouth			
DESIGN		DESIGNED STATUS	
RR		PLANNING	
APPROVED		DATE DRAWN	
DL		07/08/25	
SCALE		JOB NO.	
1:200@A3		25017.5	
DRAWN BY		REVIEWED BY	
A1		P02	
DOCUMENT ID			
250175 - STA - W - 01 - DR - A - 0102			
The copyright of this design shall remain with the Stadium Structures LTD. All rights reserved. It is not to be used in any other project without the written permission of Stadium Structures LTD.			